



DIJIWA
SANCTUARIES

 +62 361 620 0588

 Jl. Kenyeri No. 142, Tonja, Denpasar, Bali 80235, Indonesia

 info@dijiwasanctuaries.com



M
BLEU MATHIS
GILI ASAHAN

+62 812-4619-1682

Gili Asahan, Batu Putih, Kec. Sekotong, Kabupaten Lombok Barat,
Nusa Tenggara Bar. 83365

WHERE

In addition to Ubud, Gili Asahan and Umalas, Amed is considered one of Bali's most pristine regions thanks to its crystal-clear waters perfect for swimming at the beach, snorkeling and diving.

Experience an enchanting escape like no other at Bleu MATHIS Gili Asahan, a boutique resort nestled amidst the picturesque coconut grove by the sea. Just a 2.5-hour boat ride from Bali via Gili Gede

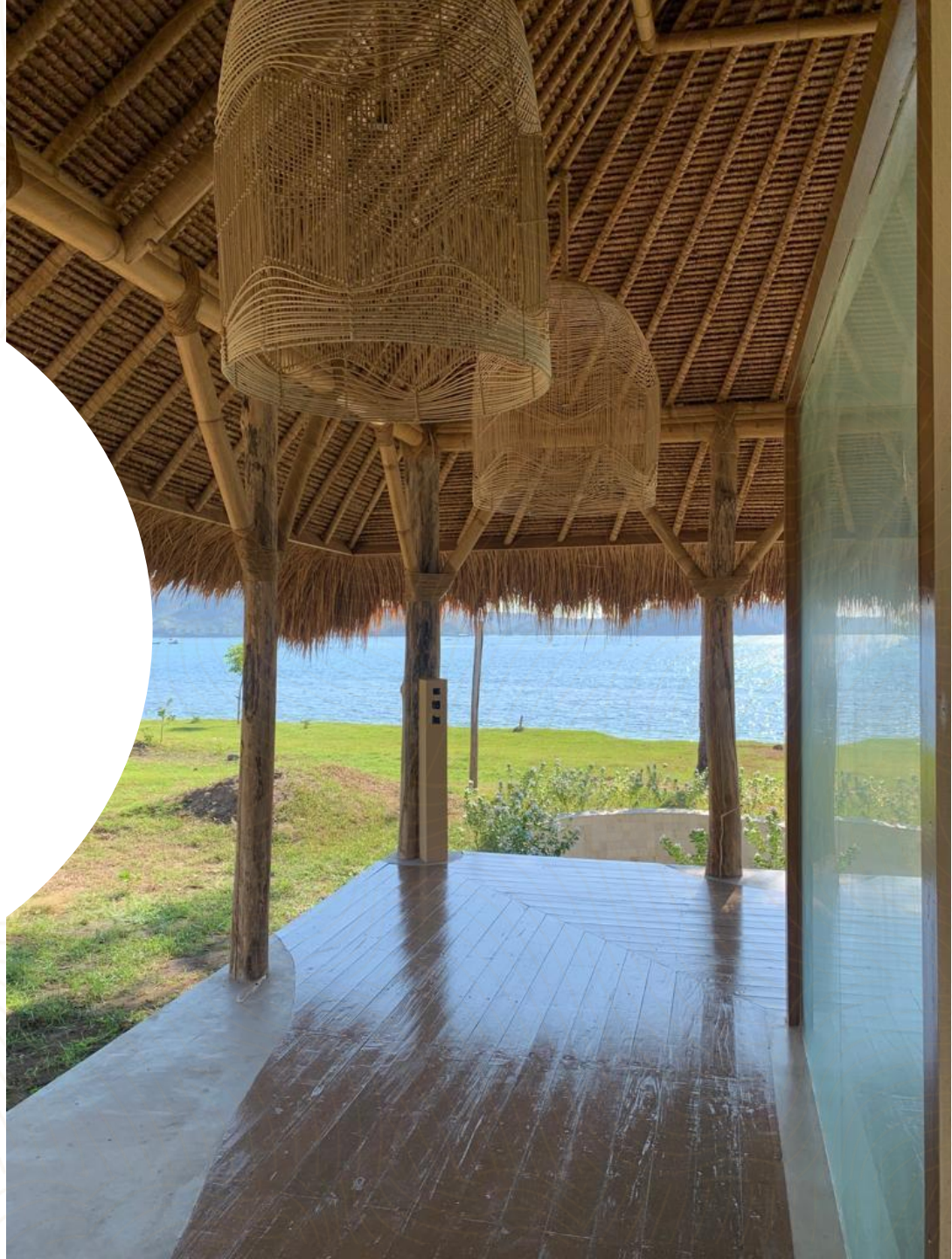



THE DESIGN

Blue MATHIS Gili Asahan is an extraordinary and captivating retreat that promises a peaceful and rejuvenating escape from the demands of modern life.

Situated amidst an enchanting landscape spanning over 2 hectares, this exquisite resort comprises of 20 private villas, each exuding an exquisite charm and adorned with a unique fusion of artistic elements inspired by the rich cultural heritage of Eastern Indonesia's diverse regions, such as Papua, Sumba, or Sumbawa.

Beyond the opulent accommodations, Blue MATHIS Gili Asahan sets itself apart with its intimate ambiance, redefining the concept of luxury resorts in the area. Embellished with the signature touches of authentic Balinese opulence found throughout the prestigious Mathis Collection, our esteemed group of properties, this retreat ensures an unrivaled experience that encapsulates the essence of Indonesian hospitality at its finest.

BLEU MATHIS GILI ASAHAN

Mathis Lodge is more than just a luxurious resort, it's a destination that offers a unique and intimate concept that is truly unmatched. From the moment you step foot on the grounds, you'll feel as though you've been transported to a world of pure indulgence and relaxation.

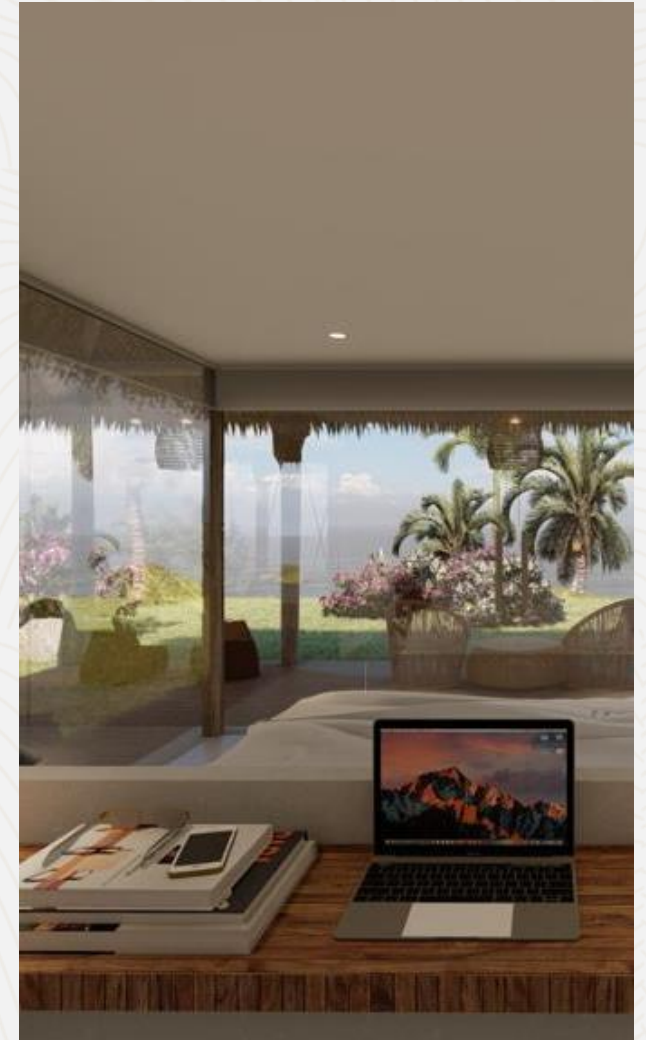



HOTEL FACILITIES



Swimming pool



Bleu Mathis
Restaurant



Room Service



Wi -Fi



Spa at MATHIS



Airport Transfer
& Boat Shuttle



No smoking
room



Parking Area

HOTEL INFORMATION

- Hotel Rating : Boutique 4 star
- Number of Rooms : 20 Rooms
- Pet Allowed : N
- Disable Facilities : N
- Check-In : 02.00 pm
- Check-Out : 12:00 noon

GUEST ACCOMMODATION

- 5 Unit – Coconut Groove Villa (35 sqm)
- 1 Unit – Coconut Groove Family Villa (35 sqm)
- 2 Unit – Coconut Groove Plunge Villa (50 sqm)
- 4 Unit – Panoramic Villa (35 sqm)
- 4 Unit – Panoramic Plunge Villa (20 Sqm)
- 1 Unit – Beach Villa (20 Sqm)
- 2 Unit – Beach Family Villa (20 Sqm)
- 2 Unit – Beach Plunge Bungalow (20 Sqm)





ROOM AMENITIES

- Individually controlled air – conditioning
- Bathroom with her & his vanity
- Writing desk
- Coffee & tea making facility
- Mathis Signature Amenities
- Safety deposit box

GUEST BENEFITS

- Welcome drink and pure napkin on arrival
- Drop and Pickup service to the Kores Harbor
- Kimono and slippers for complimentary use
- Daily 2 bottles of fresh drinking water
- Safety boxes
- Morning walks and treks





ROOM AT BLEU MATHIS

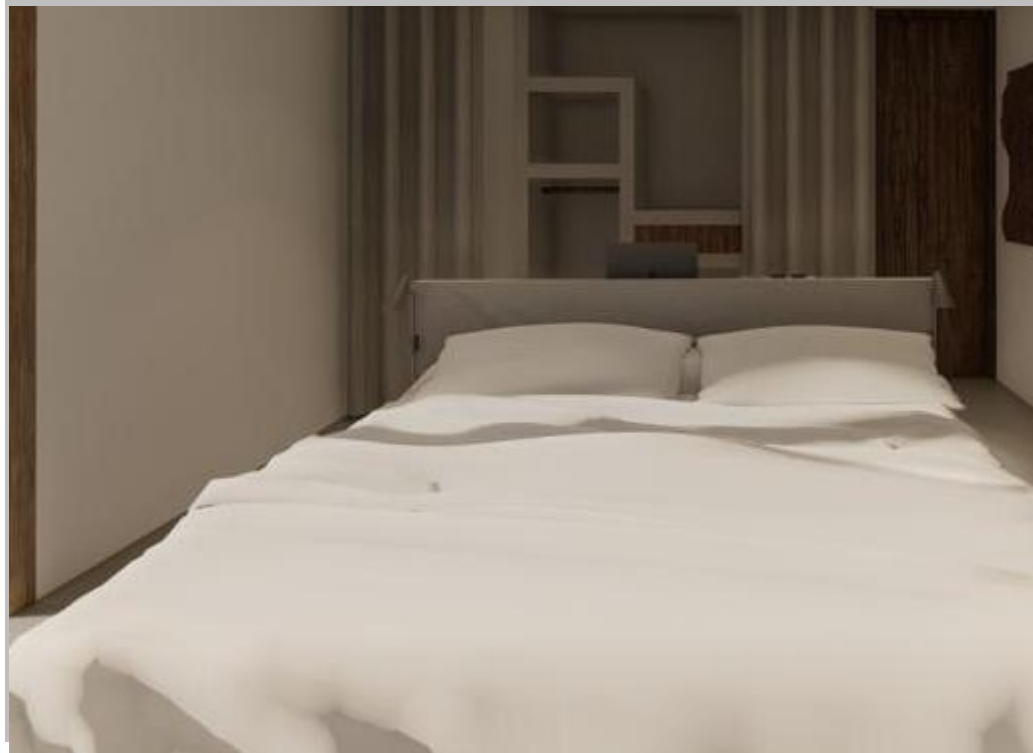

DISTANCE FROM

- Ngurah Rai Airport – 70 KM
- Benoa Harbour – 70 KM
- Padangbai Harbour – 22 KM

PLACE OF INTEREST

- | | |
|---------------------------------|------|
| • Gili Asahan Beach | 2 KM |
| • Gili Asahan Snorkelling Point | 1 KM |
| • Gili Asahan Fishing Point | 1 KM |





DIJIWA
SANCTUARIES

THANK YOU

SANCTUARY FOR THE SOUL

WHEREVER YOU GO STAY WITH US

www.dijiwasanctuaries.com